

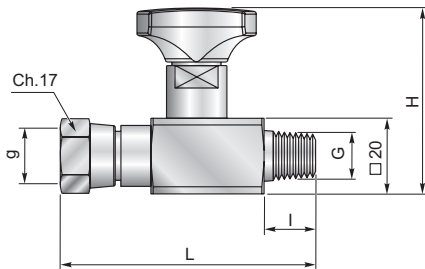

### Esclusore attacco diretto girevole

#### Anti-shock valve swivel straight connection



G	g	H	L	I	PN [bar]	Codice/Ref.
ISO 7/1 R 1/4"	ISO 228 G1/4"	50	60	14	400	ES 180

### Esclusore attacco diretto doppia femmina girevole

#### Anti-shock valve double swivel straight connection

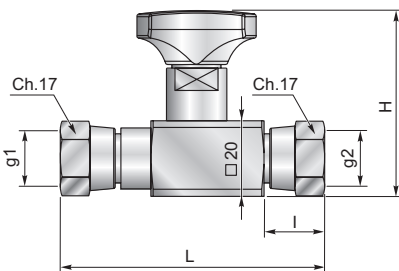

g1	g2	H	L	I	PN [bar]	Codice/Ref.
ISO 228 G1/4"	ISO 228 G1/4"	50	60	14	400	ES 18G

### Esclusore attacco diretto fisso

#### Anti-shock valve fixed straight connection

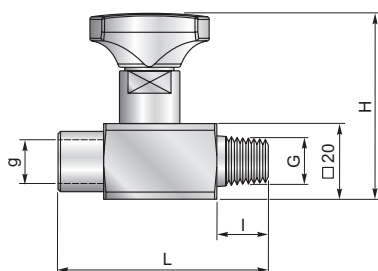

G	g	H	L	I	PN [bar]	Codice/Ref.
ISO 7/1 R 1/4"	ISO 228 G1/4"	50	58	14	400	ES 18F



**Esclusore attacco 90°**

*Anti-shock valve 90° connection*

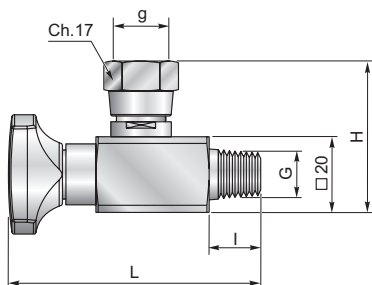

G	g	H	L	I	PN [bar]	Codice/Ref.
ISO 7/1 R 1/4"	ISO 228 G1/4"	40	68	14	400	ES 090

**Esclusore attacco 90° doppia femmina girevole**

*Anti-shock valve 90° double swivel connection*

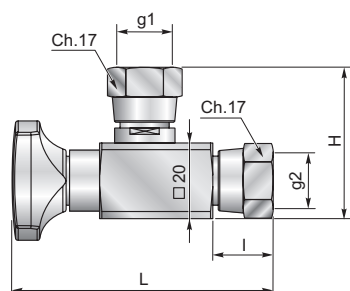

g1	g2	H	L	I	PN [bar]	Codice/Ref.
ISO 228 G1/4"	ISO 228 G1/4"	40	68	14	400	ES 09G

**Esclusore attacco fisso 90°**

*Anti-shock valve fixed 90° connection*

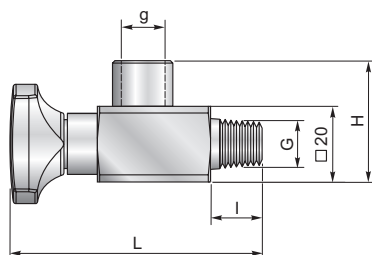

G	g	H	L	I	PN [bar]	Codice/Ref.
ISO 7/1 R 1/4"	ISO 228 G1/4"	40	68	14	400	ES 09F